

Duke TRAVELS

EXPLORING
ALASKA'S COASTAL
WILDERNESS

JUNE 12-19, 2022

ABOARD NATIONAL GEOGRAPHIC QUEST

WITH DR. TODDI STEELMAN PHD'96, P'25
STANBACK DEAN OF THE NICHOLAS
SCHOOL OF THE ENVIRONMENT



duke-travels.com

DAWES GLACIER, ENDICOTT, ALASKA

70° 21' 0" N, 147 57' 30" W

That's the
exhilaration
of discovery.



DEAR DUKE TRAVELERS,

Alaska, once known as Seward's Folly and little valued, now tops the list of travelers who seek genuine wildness. Come explore and discover the authenticity of the region with unparalleled experiences in this capital of wildness. Lindblad Expeditions' years of experience is your key to enjoying the most in-depth and engaging encounters. They know the protected coves where sea otters congregate, the river rapids where bears fish for salmon, and the rich channels where whales feed. You'll hear the thunderous crack of a calving glacier dropping ice hundreds of feet into the sea, hike the spongy trails of old-growth forests, and watch eagles fly low over quiet inlets.

Explore on the 50-cabin *National Geographic Quest*, and discover Alaska's wildness in a way only a few do. A nimble, shallow-draft expedition ship allows us to access secluded areas larger vessels simply cannot reach. The ship is equipped with a complete suite of exploration tools: Zodiacs, kayaks, and paddleboards to enable you to get out there for up-close personal discoveries. Plus there's a hydrophone, underwater video camera, and more to make your whale-watching experiences even more memorable.

And now you can experience Alaska with all your senses thanks to the culinary team aboard ship. Much of the food prepared is sourced locally from sustainable providers, with ingredients and flavors that reflect the area's wild bounty. Plus with unassigned seating, mealtimes are more than opportunities to eat well; they are also a chance to join naturalists, ship's officers, and fellow Lindblad guests to engage in stimulating conversation and gain insight into the nature and culture of the region.

The expedition team is unrivaled in their knowledge of and experience in Alaska, and will ensure that you see, do, and learn more than you ever imagined possible. Share the adventure with **Dr. Toddi Steelman PhD'96, P'25, Stanback Dean of the Nicholas School of the Environment**, along with an experienced team of naturalists who will not only accompany you on Zodiac cruises and hikes through forests, but will also introduce you to the surprising Alaska undersea. And a certified photo instructor is at your side and at your service to help you take your best photos ever.

Duke Travels is pleased to work with Lindblad Expeditions to offer you this exceptional and educational adventure. I hope you will join the exploration! **To reserve your space, please return the reservation form or call (919) 684-2988.**

Forever Duke,



Beth Ray-Schroeder '83
Director, Duke Travels
Duke Alumni Engagement and Development



DR. TODDI STEELMAN PHD'96, P'25, is the Stanback Dean of the Nicholas School of the Environment at Duke University. Working at the intersection of science, policy and decision making, her expertise in environmental and natural resource policy is well recognized nationally and internationally. Her research has been funded by the National Science Foundation and Canadian Tri Agencies as well as a variety of federal and state agencies. The author of four books, Steelman has published extensively in peer-reviewed journals, as well as opinion and editorial pieces in *Nature*, *The Globe and Mail*, *The Hill* and the *Los Angeles Times*. She is best known as a wildfire expert and has brought her expertise to bear in a variety of venues including the Royal Society (UK), National Academy of Sciences (US) and as an invited keynote speaker in Canada, Germany, Australia and the United States. She is currently the President of the International Association of Wildland Fire. Her research agenda has focused on understanding community responses to wildfire, and how communities and agencies interact for more effective wildfire management on large, interjurisdictionally complex wildfires.

Cover: Orca whales surface to breathe in quiet waters.
Opposite: Calving ice from Dawes Glacier, Southeast Alaska. © David Spiegel.
Ship's Registry: United States



EXPERIENCE ALASKA EXPEDITION STYLE

Guests explore icebergs up close.



Drawing on many years of experience exploring Alaska and a network of knowledgeable insiders, our voyage will connect you to the region in a way you never thought possible. A perfectly sized ship takes you deeper inside where you'll discover

authentic Alaska—the majestic bears, breaching humpbacks, old-growth forests, calving glaciers, inaccessible vistas, and true Alaska towns. Along the way, veteran naturalists will illuminate every facet of your expedition, providing expert commentary and spotting wildlife so you don't miss a thing. And not being tied to port times means we have the flexibility to stop and linger should we happen upon a pod of humpback or killer whales—giving you a front-row seat to the powerful, often unexpected, moments only nature can provide.

THE RICHEST WILDLIFE-WATCHING EXPERIENCE

National Geographic Quest's experienced captain and expedition staff know where to find iconic wildlife.

Their knowledge and connections with area locals, such as the Alaska Whale Foundation, means we know when to be “there” when humpback whales are—creating amazing observation and photo ops.

Researchers from the Alaska Whale Foundation come aboard to share their knowledge and latest findings,

and to provide insight into humpback behavior. The naturalists may also drop a hydrophone to reveal whale communication. You can even observe the wild undersea, as the undersea specialist dives to shoot video of the otherworldly creatures or deploys the Remotely Operated Vehicle (ROV), which you'll see on TV screens from the comfort of the lounge.



Breaching humpback.

Opposite page (clockwise from top): Brown bear; Steller sea lions; Zodiac approaching iceberg in front of Dawes Glacier; seldom-seen undersea, including this lion's mane jellyfish; bald eagle fishing.



THE PERFECT PLATFORM TO DISCOVER WILD ALASKA



Guest cruising on a Zodiac.

The *National Geographic Quest* is purpose built for exploring regions like remote Southeast Alaska. A nimble design allows you to sail into spectacular winding fjords and shallow, fast-moving channels where whales feed. You'll travel in comfort aboard a 50-cabin expedition ship carrying 100 guests. Share the thrill of spotting diving humpbacks or bears foraging along the shore from the expansive bow—and use onboard tools for deeper exploration. A fleet of Zodiacs ensures quick access from on board to shores untouched by tourist infrastructure. Single and tandem kayaks and stand-up paddleboards let you paddle in quiet coves or venture into wind- and water-carved caves.

ACTIVELY EXPLORE EVERY DAY & IN EVERY WAY

Every day brings new adventure and an array of active options. Start your morning with an energizing hike through a lush, towering forest, or choose a slower walk, with time for your naturalist to share the unique wonders of the native flora. Later on, observe a calving glacier by Zodiac, try your hand at stand-up paddleboarding, visit a typical Alaska town, or kayak along wildlife-rich shorelines keeping watch for swooping bald eagles and gregarious sea lions. When you prefer, stay aboard to read or enjoy a wellness treatment in the spa. There's never one-size-fits-all scheduling here; choose your activities at whatever level and staff members to join daily.



Alaska's still waters are perfect for kayaking.

Opposite page (clockwise from top): Hiking a forest trail; guests take advantage of Alaska's unrivaled photo ops; Zodiac approaches near to glacier; kayakers encounter a brown bear on shore; take in the epic scenery from a new vantage—on a stand-up paddleboard.



SHARE YOUR EXPEDITION WITH THE BEST TEAM



Learn, see, and do more by exploring with experts who know the region best. Share the adventure with a team of naturalists, an undersea specialist, a certified photo instructor, an expedition leader, and a video chronicler. Since personal attention is important, you explore with one staff

member for every ten guests, the best naturalist to guest ratio in Alaska. And you're able to gravitate towards individuals whose interests mirror your own—photography, the undersea, whales, botany, or something different daily. Benefit from a variety of expertise, perfectly sized groups on hikes, diverse perspectives, and engaging personalities.

CERTIFIED PHOTO INSTRUCTOR, AT YOUR SIDE & AT YOUR SERVICE

A certified photo instructor travels with you throughout your voyage. He or she is on board and in the field to assist with your camera settings, the basics of composition, and much more. Not only is the instructor an excellent photographer, more importantly, he or she is also a naturalist who can teach you how to observe and understand wildlife behavior so you aim at just the right time and place for a great shot. Now everyone, at every skill level, can go home with shots they're proud to share.



Opposite page (clockwise from top): Photo instructor points out wildlife; a pod of killer whales; enjoy naturalist-led Zodiac cruises; naturalist measures bear tracks on the forest floor; young guests observe glacier up close.

EXPLORING ALASKA'S COASTAL WILDERNESS

8 DAYS/7 NIGHTS—ABOARD NATIONAL GEOGRAPHIC QUEST



Breaching humpback whale.

Experience the remarkable beauty of Southeast Alaska on a voyage aboard a 50-cabin expedition ship into a land of mist-shrouded fjords, tidewater glaciers, and islands teeming with wildlife. Search for killer whales and humpback whales, kayak amid glacial ice, spend a full day exploring Glacier Bay National Park and learn about Alaska's rich Tlingit heritage.

DAY 1: SITKA, ALASKA/EMBARK

Arrive in Sitka, Southeast Alaska's only oceanfront town, visit the Raptor Rehabilitation Center and get close-up views of species normally seen at a distance. Embark the ship and settle into your cabin before a welcome dinner. (D)

DAY 2: SOUTHEAST ALASKA'S ISLANDS, BAYS, AND FJORDS

Today, nature is your guide. You may explore an isolated beach to take a closer look at tide pools, beach-comb, hike stunning forest trails, or see bear tracks worn into the soil while walking in an isolated meadow. Sightings of bald eagles are very common. If conditions permit, you can do some kayaking, always watching for marine and terrestrial life. (B,L,D)

DAY 3: THE INIAN ISLANDS AND ICY STRAIT

Explore among the Inian Islands, where an abundance of Steller sea lions and sea otters reside. Search for marine mammals in the rich waters of Icy Strait and choose the perfect spot around Chichagof Island to hike and kayak. (B,L,D)

DAY 4: GLACIER BAY NATIONAL PARK

See glaciers that end abruptly at the water's edge and possibly observe them "calving." Wildness abounds—mountain goats roam the cliffs and brown bears patrol the shore; Steller sea lions and puffins live in the icy waters. A native Tlingit cultural interpreter joins us to share the lore and legend of the area. We will also be joined by a National Park Service Ranger. (B,L,D)



DAY 5: FREDERICK SOUND AND CHATHAM STRAIT

With luck, see whales breaching, tail-slapping, or feeding. Later, hike or kayak for up-close exploration. Explore spectacular bays and inlets, following bear trails and salmon streams. (B,L,D)

DAY 6: PETERSBURG

Search for humpback whales as we head to the small, true Alaskan town of Petersburg. Explore a unique Southeast Alaskan ecosystem, the "muskeg," with stunted trees and carnivorous plants. Stretch your legs with an optional bike ride around town before enjoying a crab feast this evening. (B,L,D)

DAY 7: TRACY ARM-FORD'S TERROR WILDERNESS

Voyage into Tracy or Endicott Arm, both spectacular fjords with waterfalls cascading from glacially carved walls. See the soaring Dawes or South Sawyer Glacier up close, and take a cruise in a Zodiac for an unbeatable view of sculpted icebergs. Keep an eye out for harbor seals, porpoises, and arctic terns. (B,L,D)

DAY 8: JUNEAU/DISEMBARK

Disembark this morning in downtown Juneau. Take time to visit the local shops before exploring the Alaska State Museum, with its sprawling collection of natural history and cultural artifacts. Transfer to the airport for connecting flights home. (B)

Please note: All day-by-day descriptions are a sampling of the places we intend to visit, conditions permitting. Your expedition leader and captain will share your handcrafted itinerary once on board.

EXPLORE TONGASS NATIONAL FOREST

A Forest Service Special Use Permit for Tongass National Forest enables us to hike and kayak in wild and remote areas of Southeast Alaska.

PRE/POST EXTENSIONS

DENALI NATIONAL PARK

Discover the wildness that lives at the heart of Alaska on an inland exploration of Denali National Park.

CANADIAN ROCKIES & BANFF HELI-HIKING

Experience British Columbia in epic fashion with remote hiking and stunning views.

Call for pricing and details.





NATIONAL GEOGRAPHIC QUEST

CAPACITY: 50 outside cabins accommodating 100 guests.
REGISTRY: United States. **OVERALL LENGTH:** 238 feet.

National Geographic Quest is the latest addition to the Lindblad-National Geographic fleet in Alaska. Designed with over 50 years of expedition heritage and built in the U.S.A., the ship sets a new standard in exploration comfort and style.

PUBLIC AREAS: Global gallery; fitness center; LEXspa; lounge with full service bar and facilities for films and presentations; observation deck; mudroom with lockers for expedition gear, and a partially covered sundeck with chairs and tables. The open Bridge provides guests an opportunity to meet the officers and captain and learn about navigation.

MEALS: Served in single seatings with unassigned tables for an informal atmosphere and easy mingling. Breakfast is a wide-selection buffet, and lunch is often served family-style. Cuisine is fresh, sustainable, and accented with regional flair.

CABINS: All cabins face outside with windows or portholes, private facilities, and climate controls. Category 4 cabins have step-out balconies.

EXPEDITION EQUIPMENT: A fleet of 8 Zodiacs and 24 kayaks, paddleboards, Remotely Operated Vehicle (ROV), hydrophone, splash-cam, underwater video camera, and video microscope.

SPECIAL FEATURES: Guest Wi-Fi access, elevator, certified photo instructor, undersea specialist, video chronicler.

WELLNESS: The vessel is staffed by a wellness specialist and features a gym with an elliptical machine, treadmill, exercycles, handweights, and resistance bands. Treatments in the LEXspa are available by appointment.

SELF-DISINFECTING SHIPS: Lindblad Expeditions became the first self-disinfecting fleet with the rollout of the ACT CleanCoat™ system in 2019. This photocatalytic cleaning process activates when illuminated, continuously breaking down unwanted microbes such as bacteria, viruses, mold, and airborne allergens. The positive environmental impacts of this non-toxic, chemical-free system are many: less plastic in the supply chain and waste stream, and more than one million gallons of water saved annually. The system lowers our carbon footprint and creates a cleaner, healthier shipboard environment for guests and crew alike.



Above: Category 4 cabin with single beds (which can be converted to a Queen) and a private balcony; dining room with expansive windows; Category 5 cabin.

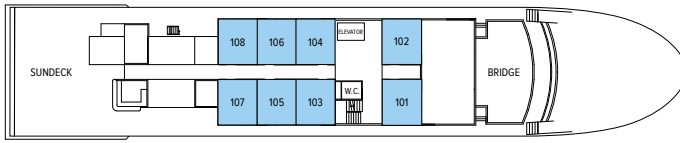

OBSERVATION DECK

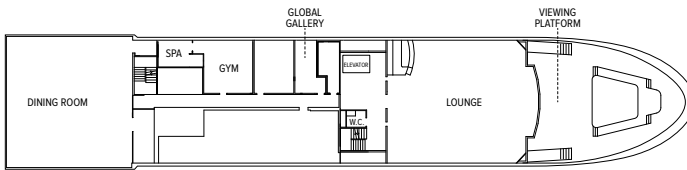

LOUNGE DECK



UPPER DECK



MAIN DECK

CATEGORY 1: Main Deck #301-306

Cabins feature two lower single beds that can convert to a Queen, a writing desk, and two portholes.

CATEGORY 2: Main Deck #307-315

Cabins feature two lower single beds that can convert to a Queen, a writing desk, and two portholes.

CATEGORY 3: Upper Deck #201-206 Cabins feature two lower single beds that can convert to a Queen, a writing desk, and two large view windows.

CATEGORY 4: Upper Deck #207-229 Cabins feature two lower single beds that can convert to a Queen, a writing desk, sliding glass door, and small, private balcony.

CATEGORY 5 (SUITE): Observation Deck #101-108

Cabins feature two lower single beds that can convert to a Queen, large view windows, an expanded bathroom, writing desk, ample storage space, and a convertible sofa bed to accommodate a third person.

NOTE: Solo Occupancy cabins are available in Categories 1 and 2 only. Third person rates are available in Category 5 cabins at one half the double occupancy rate.

Connecting Cabins via internal doorway access: Main Deck: #312-314, #311-315, #306-308, #305-307; Upper Deck: #224-226, #225-227

Prices are per person, double occupancy unless indicated as solo.

ITINERARY	CAT. 1	CAT. 2	CAT. 3	CAT. 4	CAT. 5 SUITE	CAT. 1 SOLO	CAT. 2 SOLO	ADVANCE PAYMENT	AIRFARES
Exploring Alaska's Coastal Wilderness	\$7,340	\$8,150	\$8,620	\$9,580	\$10,600	\$11,010	\$12,140	\$750	Lindblad Expeditions will assist in making your air arrangements.

INCLUSIVE PRICING

ABOARD SHIP

- ✓ All meals and nonalcoholic beverages
- ✓ 24-hour coffee, tea and soda
- ✓ Hors d'oeuvres and snacks during evening Recaps
- ✓ Environmentally friendly refillable water bottle with bottle refill stations
- ✓ Fully stocked library
- ✓ Fitness equipment
- ✓ The guidance and company of the expedition staff

ASHORE

- ✓ Special access permits, park fees, port taxes
- ✓ Transfers to and from group flights
- ✓ The expertise of the expedition staff

ACTIVITIES

- ✓ All shore activities (except optional flightseeing)
- ✓ Zodiac explorations
- ✓ Kayaking and paddleboarding
- ✓ Lectures and presentations in the lounge, including special presentations from the Alaska Whale Foundation and a Tlingit cultural interpreter
- ✓ Photo instruction
- ✓ Morning stretch classes with wellness specialist

SPECIAL OFFERS

MILESTONES CELEBRATION PACKAGE: Celebrate with your group of eight or more, and you will be entitled to: 5% off; \$150 shipboard credit; complimentary video chronicle, and more. Milestone celebration needs to be communicated at time of booking, amenity package is one per group and intended for the guest celebrating the Milestone event. Group discount is applicable to cruise portion only, and does not apply towards additional services such as hotels, extensions, etc. Group cancellation terms also apply. Not combinable with certain offers.

BRING THE KIDS: Sharing an expedition with your kids or grandkids is a life-enhancing experience. So, take \$500 off the double occupancy price for each person under 18.

TERMS AND CONDITIONS

VOYAGE COST INCLUDES: All accommodations aboard ship; all meals and nonalcoholic beverages aboard ship; shore excursions, sightseeing, and entrance fees; use of kayaks and paddleboards; special access permit; transfers to and from group flights; tips (except to ship's crew), taxes, and service charges, and services of the expedition staff. Unused services or items included in this program are non-refundable.

NOT INCLUDED: Air transportation; passport, visa, immigration fees; meals not indicated; optional floatplane excursion; travel protection plan; items of a personal nature such as: alcoholic beverages aboard ship, Wi-Fi access, voyage chronicle, and laundry. Gratuities to ship's crew are at your discretion.

OFFER COMBINABILITY: Guests can apply two offers, at most, but with limited availability. All offers are valid for new bookings only, subject to availability, not applicable on pre or post-voyage extensions, and may not be combinable with other offers.

AIRFARE: Airfare is an additional cost. Lindblad Expeditions will assist in making your air arrangements for a \$50 per person service fee.

RESERVATIONS: To confirm your place, an advance payment of US\$750 per person is payable by check, Visa, MasterCard, American Express, or Discover.

FINAL PAYMENT: Due 90 days prior to departure.

TRAVEL PROTECTION PLAN: Travel and medical insurance are available at an additional cost. Information will be sent to you by Duke Alumni Association upon registration.

ENTRY AND VISA REQUIREMENTS: Guests are advised to verify travel documents (passport or REAL ID/transit visa/entry visa) for the country through which they are transiting and/or entering. Reliable and most current information regarding international travel can be found by contacting the consulate/embassy of the country(s) you are visiting or transiting through. We will not be responsible if you are denied entry or transit into a country, if you are unable to provide valid documents as per the country's requirement.

SMOKING AND VAPING POLICY: Allowed only in designated outdoor areas.

RESPONSIBILITY AND OTHER TERMS & CONDITIONS: Certain other provisions concerning, among other things, limitations of Lindblad Expeditions' and the National Geographic Expeditions' (a division of National Geographic Partners, LLC) liability for loss of property, injury, illness, or death during the voyage will be provided to all guests on the ship's ticket sent prior to departure or upon request. By registering for a trip, the guest agrees to all such terms and conditions.

NOTE: Itinerary and prices listed in this brochure are as of publication date and are subject to change. Under normal conditions the total expedition price is guaranteed at the time of booking. However, the expedition pricing is determined far in advance of initial departure on the basis of then-existing projections of fuel and other costs. In the event of increases in those costs, including but not limited to increases in the price of fuel, currency fluctuations, increases in government taxes or levies, or increased security costs, the right is reserved to adjust the price of your expedition or add a surcharge to cover such unexpected increases. We will always provide an explanation of the reason for increase in costs.

PHOTO CREDITS: Marc Cappelletti, Eric Guth, Ralph Lee Hopkins, Michael S. Nolan, Jeff Litton, Ryder Redfield, Rich Reid, Max Seigal, David Spiegel, David Vargas

CANCELLATION POLICY	
Number of Days Prior to Expedition Start	Per Person Cancellation Fee
120 or more days	\$350
119–90 days	Advance payment cost
89–60 days	25% of trip cost
59–45 days	50% of trip cost
44-0 days	No refund

This policy applies to the voyage only. We strongly recommend that you purchase a travel protection plan.



Please call to reserve:
Phone: (919) 684-2988

Or please send reservation to:
Duke Travels
Box 90572
Durham, NC 27708
Email: duketravels@duke.edu

RESERVATION FORM: EXPLORING ALASKA'S COASTAL WILDERNESS ABOARD NATIONAL GEOGRAPHIC QUEST • JUNE 12-19, 2022

Please reserve _____ place(s).

Name 1: _____
(As it appears on I.D.)

Name 1: _____ Date of Birth: _____
(Preferred name for name badge)

Name 2: _____
(As it appears on I.D.)

Name 2: _____ Date of Birth: _____
(Preferred name for name badge)

Street Address: _____

City: _____ State: _____ Zip: _____

Home Phone: _____ Business Phone: _____

Cell Phone: _____ Email: _____

Accommodations: Double Single Twin share w/friend
 Share with roommate assigned by tour operator

Please indicate choice of cabin category in order of preference:

1st choice: _____ 2nd choice: _____

Please send me information on the **Denali National Park**
 Canadian Rockies & Banff Heli-Hiking extension.

Advance Payment Information: US\$750 per person.

If paying by check, please make payable to: **Lindblad Expeditions, Inc.**

Enclosed is my advance payment of \$ _____

If paying by credit card, we will contact you to finalize your booking and collect payment information.

EXPLORING ALASKA'S COASTAL WILDERNESS

EXPEDITION HIGHLIGHTS

- » Travel with Dr. Todd Steelman PhD'96, P'25, Stanback Dean of the Duke's Nicholas School of the Environment.
- » Kayak into protected coves and look for sea otters, seabirds, and harbor seals.
- » Hike through lush forests to cascading waterfalls, and cruise on a Zodiac into coves to search for brown bears.
- » Meet members of the Alaska Whale Foundation to learn about the local whale population, and gain insight on Alaska's indigenous people from a Tlingit cultural interpreter.
- » Discover Alaska's seldom-seen, vibrant marine life revealed by an undersea specialist.

100% CARBON NEUTRAL SINGLE-USE PLASTIC FREE

We have chosen Lindblad Expeditions because they care deeply about the planet, and see travel as a powerful force for good.

 Printed on 10% recycled content paper with soy-based inks. We recommend that you pass this along for others to enjoy or recycle.



Duke TRAVELS

Duke Travels
Box 90572
Durham, NC 27708

PRSR STD
U.S. POSTAGE
PAID
LINDBLAD
EXPEDITIONS

GRP-DART-ALAS22